

# BASTROP COUNTY ELECTION PRECINCT 1006

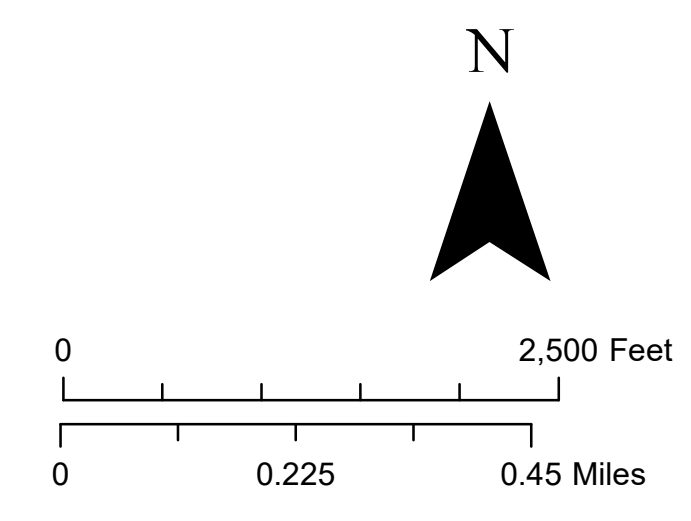

Election Precinct 1006

	1001		1006		2011		2016		4021
	1002		1007		2012		3017		4022
	1003		1008		2013		3018		4023
	1004		1009		2014		3019		4024
	1005		2010		2015		3020		4025
							4026		

- Public Highway
- FM Road
- Public Road
- Private Road
- Other Access
- Rail Road
- County Line
- City Limit
- Colorado River
- Lake

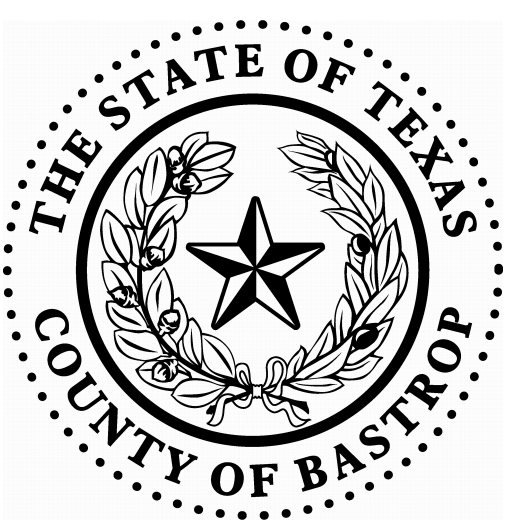

DISCLAIMER  
Bastrop County provides this map "as is" and assumes no liability for its completeness or accuracy. Information shown on this map is derived from public records that are constantly undergoing change and do not replace a site survey. This product is for informational purposes and may not have been prepared for or be suitable for legal, engineering or surveying purposes. It does not represent an on-site ground survey and represents only the approximate relative location of property boundaries.

Map Title: Bastrop County Election Precinct 1006  
Produced By: Bastrop County Information Technology  
Author: Julie Sommerfeld  
Date: 1/24/2022 at 1:52:07 PM  
Bastrop County  
Date Expired: 01-25-22

